



FOR LEASE

75-77 BANNISTER RD



BRETT INTRATER

SENIOR VICE PRESIDENT

BRETT INTRATER PERSONAL REAL ESTATE CORPORATION

T 204 934 6229

C 204 999 1238

E BRETT.INTRATER@CWSTEVENSON.CA

RYAN MUNT

SENIOR VICE PRESIDENT

RYAN MUNT PERSONAL REAL ESTATE CORPORATION

T 204 928 5015

C 204 298 1905

E RYAN.MUNT@CWSTEVENSON.CA



PROPERTY HIGHLIGHTS

(+/-) 16,628 sf Available

- Excellent warehouse/office space located in Northwest Winnipeg
- Close proximity to major routes and the Winnipeg Richardson International Airport
- Includes approximately (+/-) 1,100 sf fully built out office space
- 4 dock doors
- 2 grade doors
- Ample parking on-site
- 24' clear ceiling height

LEASE RATE: \$11.95 PSF NET

CAM & TAX: \$4.59 PSF (2023 ESTIMATE)

plus management fee 5% gross rent

AREA MAP



Winnipeg Airport

5 MINS

Trans Canada Hwy:

10 MINS

Perimeter Hwy:

32 MINS

US Border:

90 MINS





FLOOR PLAN

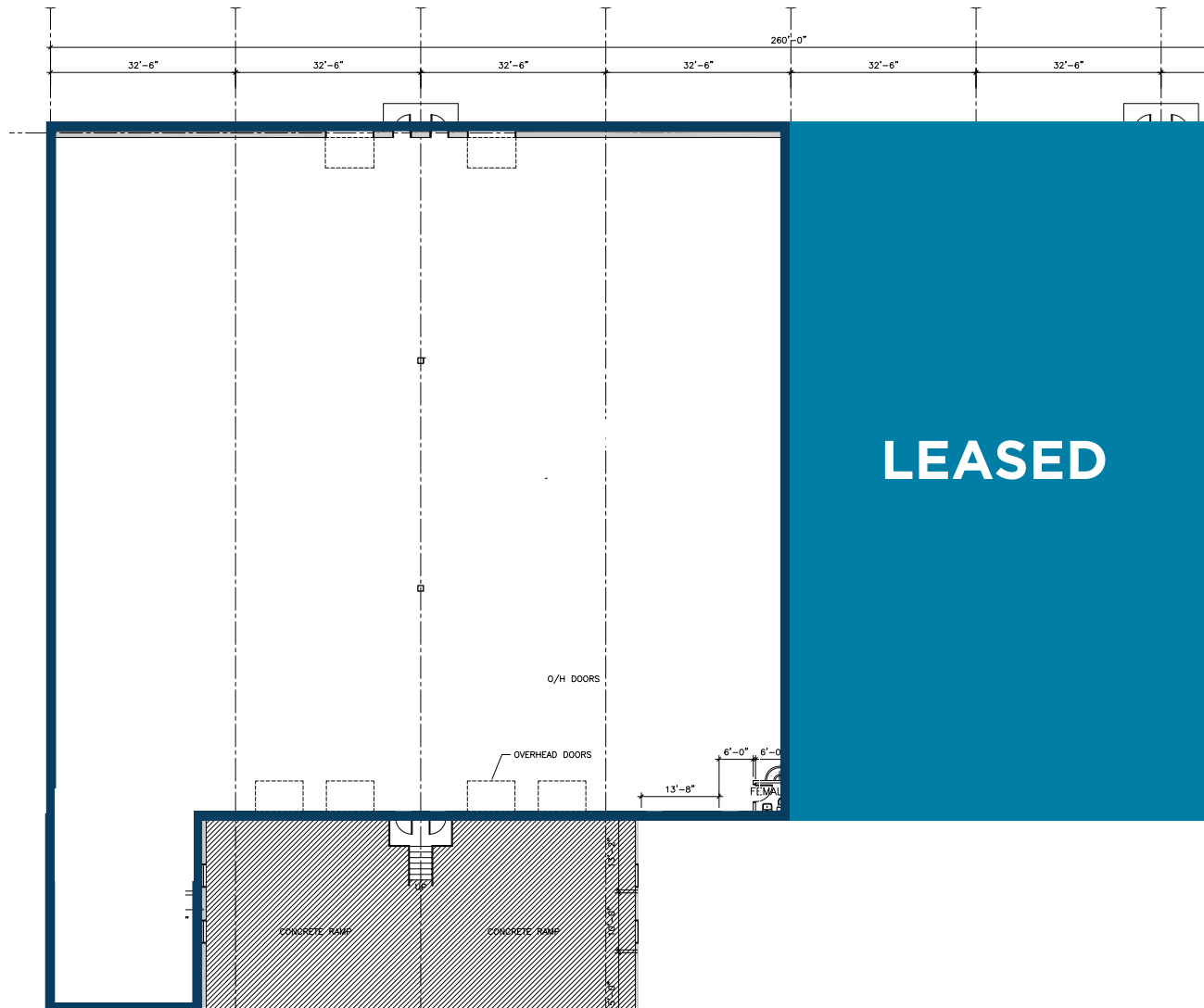



CONTACT

BRETT INTRATER SENIOR VICE PRESIDENT

BRETT INTRATER PERSONAL REAL ESTATE CORPORATION

T 204 934 6229
C 204 999 1238
E BRETT.INTRATER@CWSTEVENSON.CA

RYAN MUNT SENIOR VICE PRESIDENT

RYAN MUNT PERSONAL REAL ESTATE CORPORATION

T 204 928 5015
C 204 298 1905
E RYAN.MUNT@CWSTEVENSON.CA

Independently Owned and Operated / A Member of the Cushman & Wakefield Alliance ©2022 Cushman & Wakefield. All rights reserved. The information contained in this communication is strictly confidential.

This information has been obtained from sources believed to be reliable but has not been verified.

NO WARRANTY OR REPRESENTATION, EXPRESS OR IMPLIED, IS MADE AS TO THE CONDITION OF THE PROPERTY (OR PROPERTIES) REFERENCED HEREIN OR AS TO THE ACCURACY OR COMPLETENESS OF THE INFORMATION CONTAINED HEREIN, AND SAME IS SUBMITTED SUBJECT TO ERRORS, OMISSIONS, CHANGE OF PRICE, RENTAL OR OTHER CONDITIONS, WITHDRAWAL WITHOUT NOTICE, AND TO ANY SPECIAL LISTING CONDITIONS IMPOSED BY THE PROPERTY OWNER(S). ANY PROJECTIONS, OPINIONS OR ESTIMATES ARE SUBJECT TO UNCERTAINTY AND DO NOT SIGNIFY CURRENT OR FUTURE PROPERTY PERFORMANCE.

