

FOR LEASE

UNIT D

1000 Waverley Street

Fully Developed Office Space Available

Ryan Munt
Senior Vice President

Ryan Munt Personal Real Estate Corporation
T 204 928 5015
C 204 298 1905
ryan.munt@cwstevenson.ca

Shae Halpin

Associate
T 204 560 2536
C 204 558 6071
shae.halpin@cwstevenson.ca



**CUSHMAN &
WAKEFIELD**
Winnipeg



Stevenson

FOR LEASE

1000 Waverley Street



(+/-) 24,825 sf Available with Bonus Mezzanine and 80 Parking Stalls

PROPERTY HIGHLIGHTS

- Fully developed office space located in highly desirable Southwest Winnipeg
- (+/-) 8,144 sf bonus mezzanine included at no additional cost
- Mix of private perimeter and interior offices, open work areas, one large boardroom, meeting rooms, copy room, storage rooms, bike storage, men's and women's showers and a recently renovated lunch room
- Well-situated within densely populated, amenity-rich area
- Large monument sign available with excellent visibility along Waverley Street
- City of Winnipeg transit stops going North and South located directly outside
- (+/-) 80 parking stalls available on site
- Available November 2023
- Zoned M2

Lease Rate: \$18.50 psf Net

CAM & Tax: \$7.48 psf (2025 est.)

Includes utilities

plus mgmt fee 5% of net rent

FOR LEASE

Unit D 1000 Waverley St



FOR LEASE

Unit D 1000 Waverley St



FOR LEASE

Unit D 1000 Waverley St



FLOOR PLAN

(+/-) 24,825 sf Available
with Bonus Mezzanine

- Offices - 36
- Boardroom - 1
- Meeting Rooms - 4
- Kitchenette - 1
- Lunchroom - 1
- Tech Rooms - 2
- Storage - 5

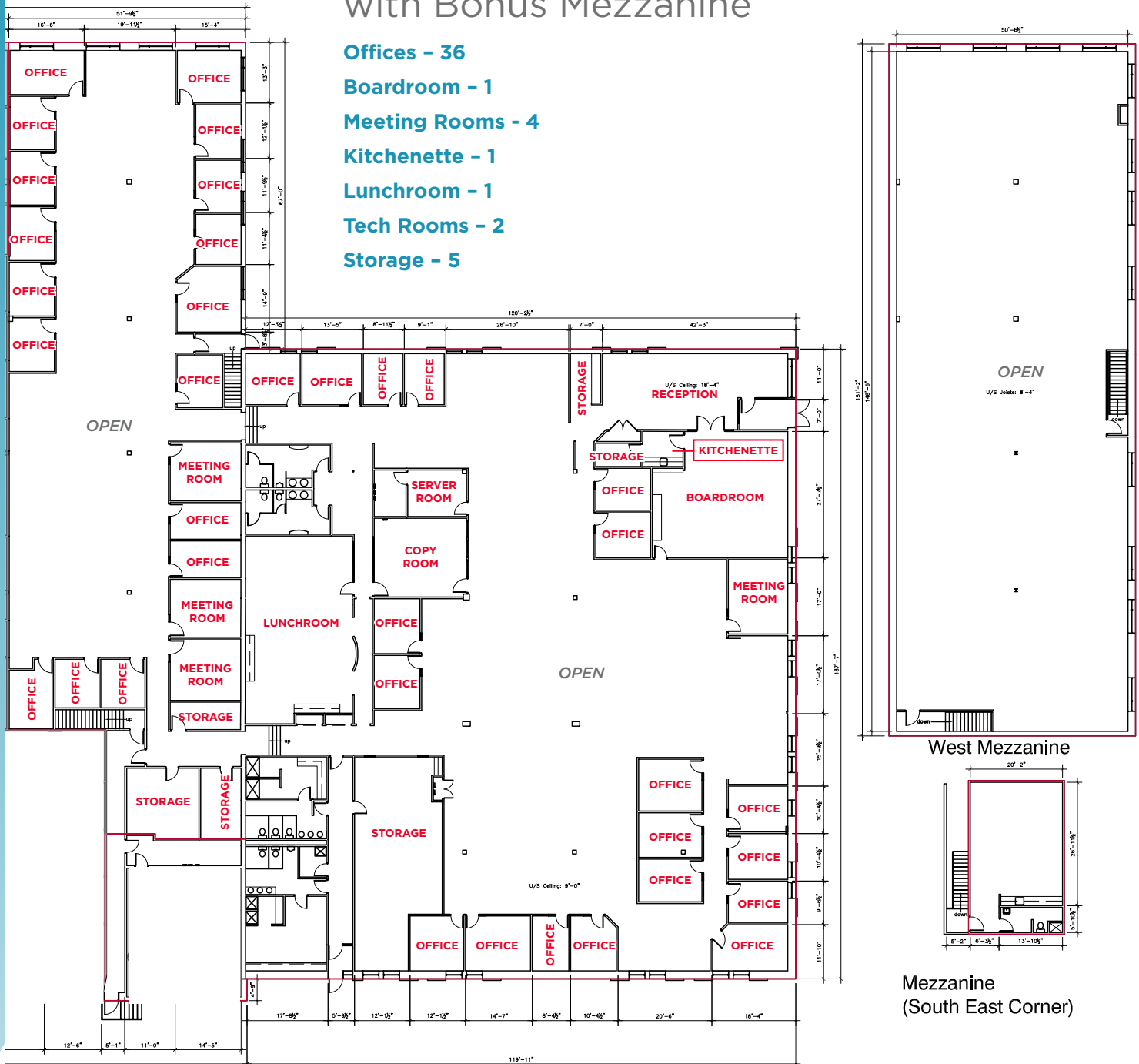

FOR LEASE

Unit D 1000 Waverley St

SITE PLAN

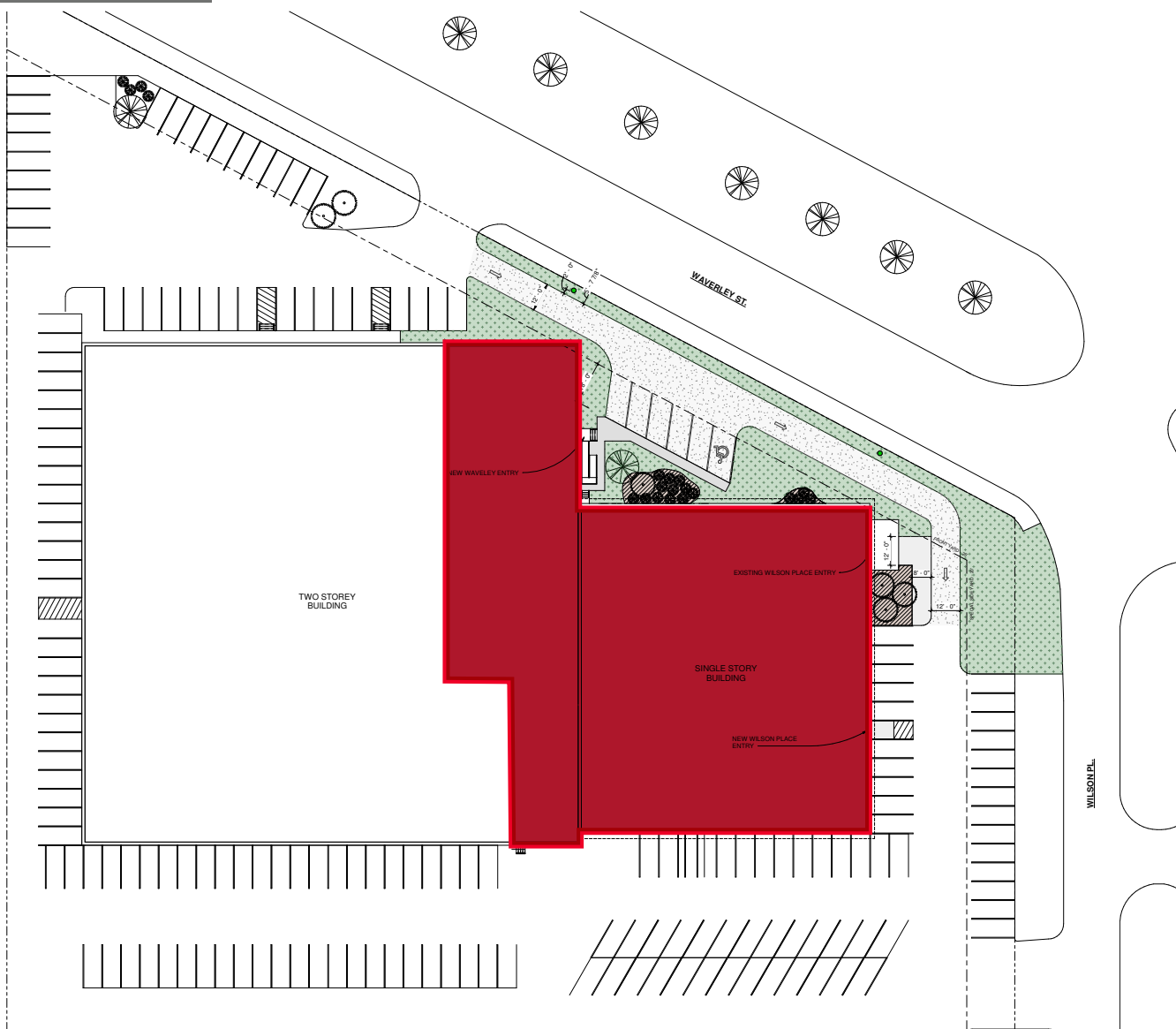

FOR LEASE

Unit D 1000 Waverley St

CUSHMAN & WAKEFIELD
Winnipeg

Stevenson



DEMOGRAPHICS

	POPULATION	MEDIAN AGE	AVERAGE HHI	TOTAL HOUSEHOLDS
1KM	4,174	48	\$146,833.91	1,707
3KM	49,042	43	\$107,706.96	21,168
5KM	148,431	41	\$113,324.96	64,588

Independently Owned and Operated / A Member of the Cushman & Wakefield Alliance ©2023 Cushman & Wakefield. All rights reserved. The information contained in this communication is strictly confidential. This information has been obtained from sources believed to be reliable but has not been verified. NO WARRANTY OR REPRESENTATION, EXPRESS OR IMPLIED, IS MADE AS TO THE CONDITION OF THE PROPERTY (OR PROPERTIES) REFERENCED HEREIN OR AS TO THE ACCURACY OR COMPLETENESS OF THE INFORMATION CONTAINED HEREIN, AND SAME IS SUBMITTED SUBJECT TO ERRORS, OMISSIONS, CHANGE OF PRICE, RENTAL OR OTHER CONDITIONS, WITHDRAWAL WITHOUT NOTICE, AND TO ANY SPECIAL LISTING CONDITIONS IMPOSED BY THE PROPERTY OWNER(S). ANY PROJECTIONS, OPINIONS OR ESTIMATES ARE SUBJECT TO UNCERTAINTY AND DO NOT SIGNIFY CURRENT OR FUTURE PROPERTY PERFORMANCE.

Ryan Munt
Senior Vice President

Ryan Munt Personal Real Estate Corporation
T 204 928 5015
C 204 298 1905
ryan.munt@cwstevenson.ca

Shae Halpin

Associate

T 204 560 2536
C 204 558 6071
shae.halpin@cwstevenson.ca

Independently Owned and Operated / A Member of the Cushman & Wakefield Alliance ©2023 Cushman & Wakefield. All rights reserved.
The information contained in this communication is strictly confidential.

This information has been obtained from sources believed to be reliable but has not been verified. NO WARRANTY OR REPRESENTATION, EXPRESS OR IMPLIED, IS MADE AS TO THE CONDITION OF THE PROPERTY (OR PROPERTIES) REFERENCED HEREIN OR AS TO THE ACCURACY OR COMPLETENESS OF THE INFORMATION CONTAINED HEREIN, AND SAME IS SUBMITTED SUBJECT TO ERRORS, OMISSIONS, CHANGE OF PRICE, RENTAL OR OTHER CONDITIONS, WITHDRAWAL WITHOUT NOTICE, AND TO ANY SPECIAL LISTING CONDITIONS IMPOSED BY THE PROPERTY OWNER(S). ANY PROJECTIONS, OPINIONS OR ESTIMATES ARE SUBJECT TO UNCERTAINTY AND DO NOT SIGNIFY CURRENT OR FUTURE PROPERTY PERFORMANCE.

