

INDUSTRIAL FOR LEASE

21 John Hiebert Drive RM of Springfield

1,500 - 3,000 sf Available

Ryan Munt

Senior Vice President

Ryan Munt Personal Real

Estate Corporation

T 204 928 5015

C 204 298 1905

ryan.munt@cwstevenson.ca



INDUSTRIAL FOR LEASE

21 John Hiebert Drive RM of Springfield



Industrial bays available 4 minutes from the Perimeter Highway

PROPERTY HIGHLIGHTS

- Situated just east of the City of Winnipeg and 2 minutes from Dugald Road and 4 minutes from the Perimeter Highway
- Each unit has 1 - 14'x14' grade loading door
- Floor drain in each unit
- Construction underway, available Spring 2024

COMPOUND SPACE AVAILABLE

Lease Rate: Starting at \$1,750 Per Month
CAM & Tax: \$375 Per Month (2023 est.)

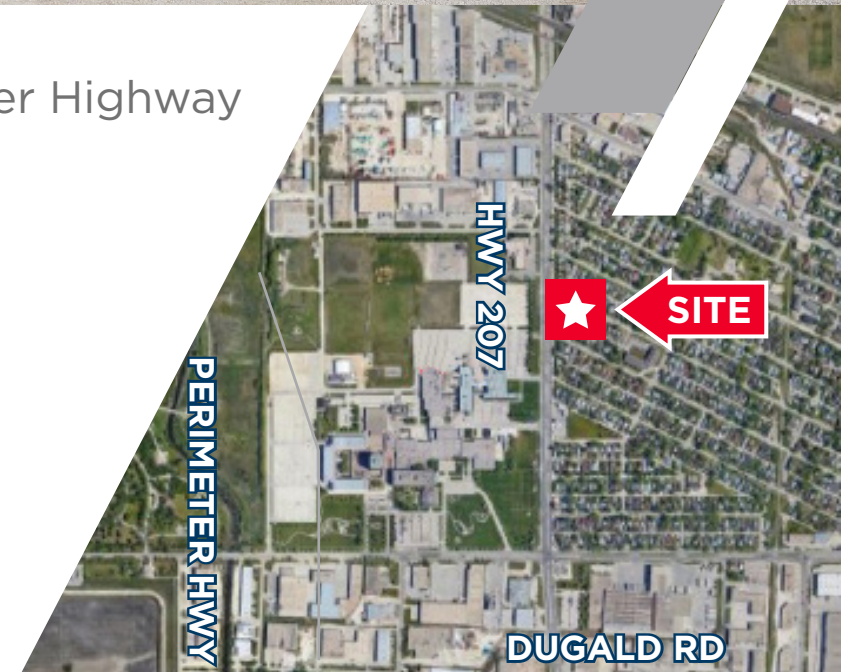

INDUSTRIAL FOR LEASE

21 John Hiebert Drive - RM of Springfield

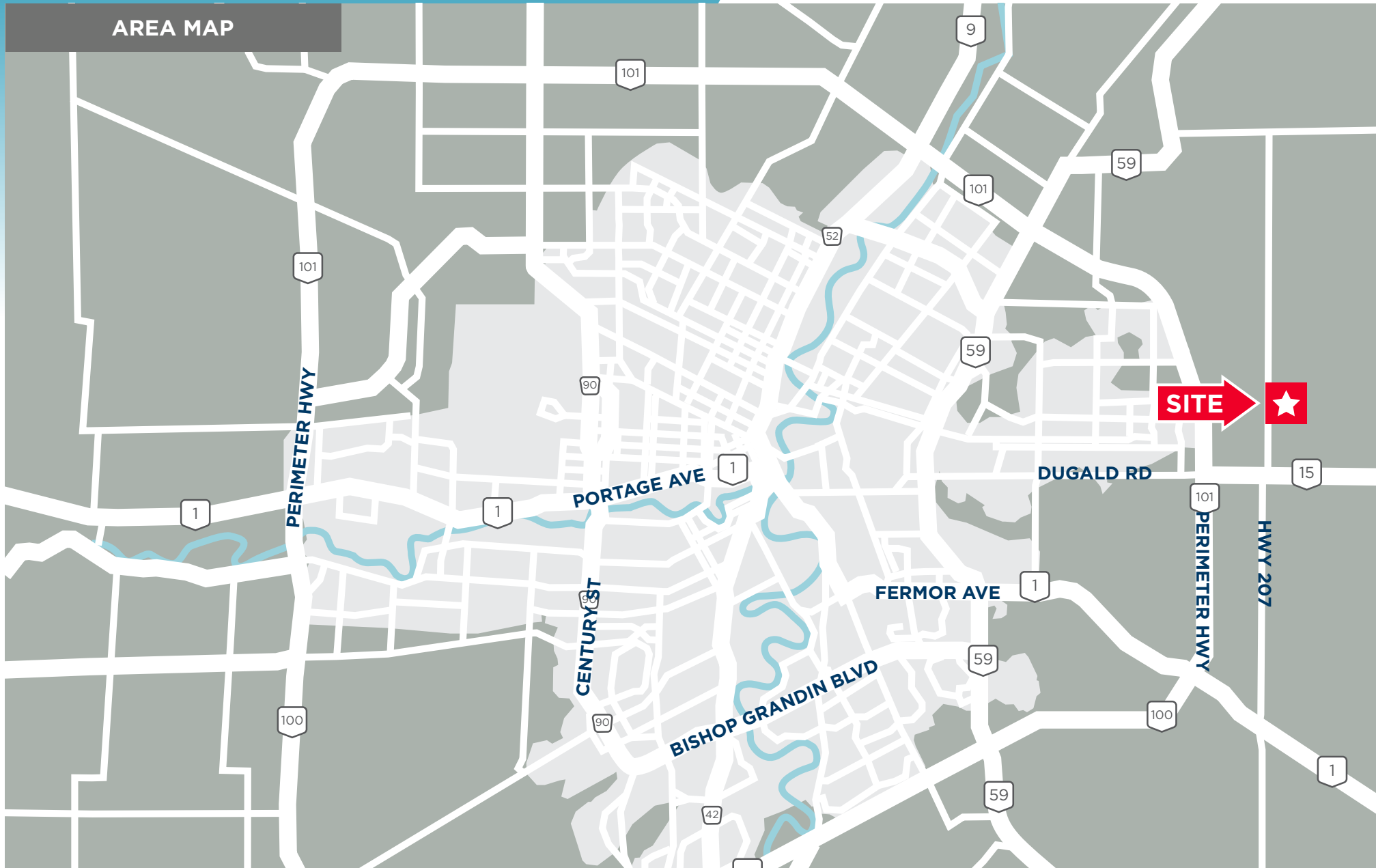

Independently Owned and Operated / A Member of the Cushman & Wakefield Alliance ©2022 Cushman & Wakefield. All rights reserved. The information contained in this communication is strictly confidential. This information has been obtained from sources believed to be reliable but has not been verified. NO WARRANTY OR REPRESENTATION, EXPRESS OR IMPLIED, IS MADE AS TO THE CONDITION OF THE PROPERTY (OR PROPERTIES) REFERENCED HEREIN OR AS TO THE ACCURACY OR COMPLETENESS OF THE INFORMATION CONTAINED HEREIN, AND SAME IS SUBMITTED SUBJECT TO ERRORS, OMISSIONS, CHANGE OF PRICE, RENTAL OR OTHER CONDITIONS, WITHDRAWAL WITHOUT NOTICE, AND TO ANY SPECIAL LISTING CONDITIONS IMPOSED BY THE PROPERTY OWNER(S). ANY PROJECTIONS, OPINIONS OR ESTIMATES ARE SUBJECT TO UNCERTAINTY AND DO NOT SIGNIFY CURRENT OR FUTURE PROPERTY PERFORMANCE.

INDUSTRIAL FOR LEASE

21 John Hiebert Drive - RM of Springfield

SITE PLAN

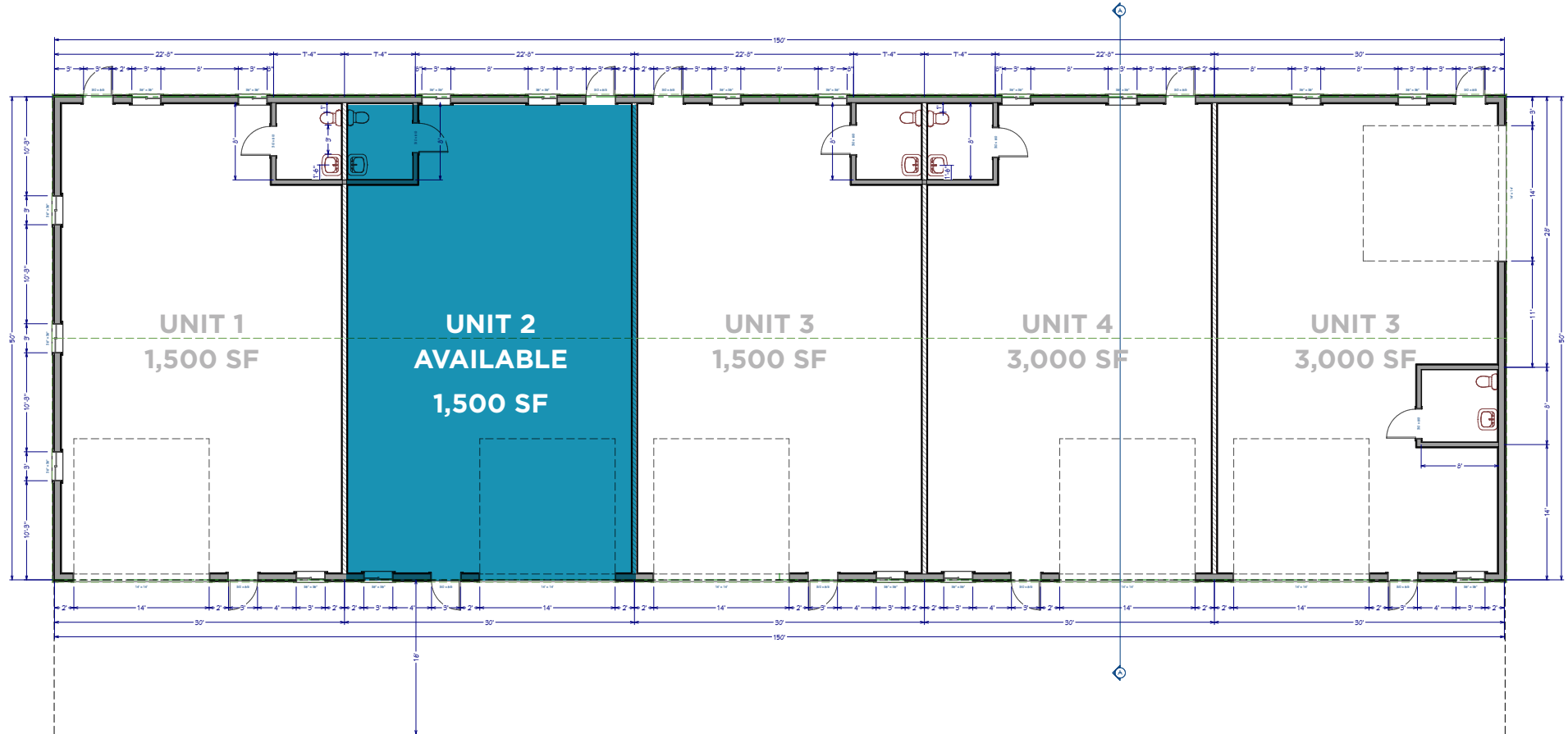

Ryan Munt
Senior Vice President

*Ryan Munt Personal
Real Estate Corporation*

T 204 928 5015

C 204 298 1905

ryan.munt@cwstevenson.ca

Independently Owned and Operated / A Member of the Cushman & Wakefield Alliance ©2022 Cushman & Wakefield. All rights reserved. The information contained in this communication is strictly confidential. This information has been obtained from sources believed to be reliable but has not been verified. NO WARRANTY OR REPRESENTATION, EXPRESS OR IMPLIED, IS MADE AS TO THE CONDITION OF THE PROPERTY (OR PROPERTIES) REFERENCED HEREIN OR AS TO THE ACCURACY OR COMPLETENESS OF THE INFORMATION CONTAINED HEREIN, AND SAME IS SUBMITTED SUBJECT TO ERRORS, OMISSIONS, CHANGE OF PRICE, RENTAL OR OTHER CONDITIONS, WITHDRAWAL WITHOUT NOTICE, AND TO ANY SPECIAL LISTING CONDITIONS IMPOSED BY THE PROPERTY OWNER(S). ANY PROJECTIONS, OPINIONS OR ESTIMATES ARE SUBJECT TO UNCERTAINTY AND DO NOT SIGNIFY CURRENT OR FUTURE PROPERTY PERFORMANCE.

