

WORSHIP CENTRE FOR SALE IN SOUTHWEST WINNIPEG -
PERFECT FOR WORSHIP CENTRE, MEDICAL, OR OFFICE USE

50 SCURFIELD BOULEVARD



Chris Hourihan
Associate Vice President
C 204 995 0225
T 204 934 6215
chris.hourihan@cwstevenson.ca



**CUSHMAN &
WAKEFIELD**
Winnipeg



Stevenson



PROPERTY HIGHLIGHTS

(+/-) 11,511 SF AVAILABLE

- Located in the heart of Southwest Winnipeg fronting Scurfield Boulevard, between McGillivray Boulevard and Waverley Street.
- Situated between some of Winnipeg's most affluent neighbourhoods and surrounded by nearby retail and service-oriented amenities
- Phenomenal parking with 106 parking stalls
- Turn-key Worship Centre, with adaptability for various office uses after renovations
- Building and pylon signage opportunities (existing pylon sign infrastructure in place, with pylon sign removed)
- Excellent security with exterior and interior security system installed.
- Site to be fully fenced/gated (construction ongoing)
- Zoned M2

PRICING

Asking Price:	\$4,500,000
Price Per sq. ft:	\$391
Property Taxes:	\$3,919.33 (2025)

SITE DETAILS

Land Area:	1.87 acres (80,173 sq. ft.)
Legal Description:	LOT 8 BLOCK 5 PLAN 15345 WLTO IN OTM LOTS 16 TO 23 PARISH OF ST. VITAL
Frontage:	563.94'

BUILDING DETAILS

Building Area:	11,511 sq. ft.
Storeys:	1 (no basement)
Year Built:	1987
Parking:	106 stalls
Structure:	Wood frame
Monthly Costs:	Owner averages monthly costs of \$2,070 (hydro, gas, and refuse)

MAIN IMAGES



AERIAL VIEW



DEMOGRAPHICS

MAP

DRIVE TIME

- 9 MINS TO PERIMETER HWY
- 20 MINS TO DOWNTOWN WINNIPEG



AMENITIES MAP

- | | | | |
|---|------------------------|----|-------------------------------|
| 1 | RONA+ | 9 | COSTCO |
| 2 | BEN & FLORENTINE | 10 | COSTCO GAS STATION |
| 3 | PETSMART | 11 | CLAY OVEN |
| 4 | THE CANADIAN BREWHOUSE | 12 | INDIGO |
| 5 | STARBUCKS | 13 | JOEY |
| 6 | THE KEG STEAKHOUSE | 14 | CHILLI CHUTNEY STREET KITCHEN |
| 7 | A&W | 15 | WALMART |
| 8 | CINEPLEX ODEON | 16 | THE HOME DEPOT |



FLOOR PLAN

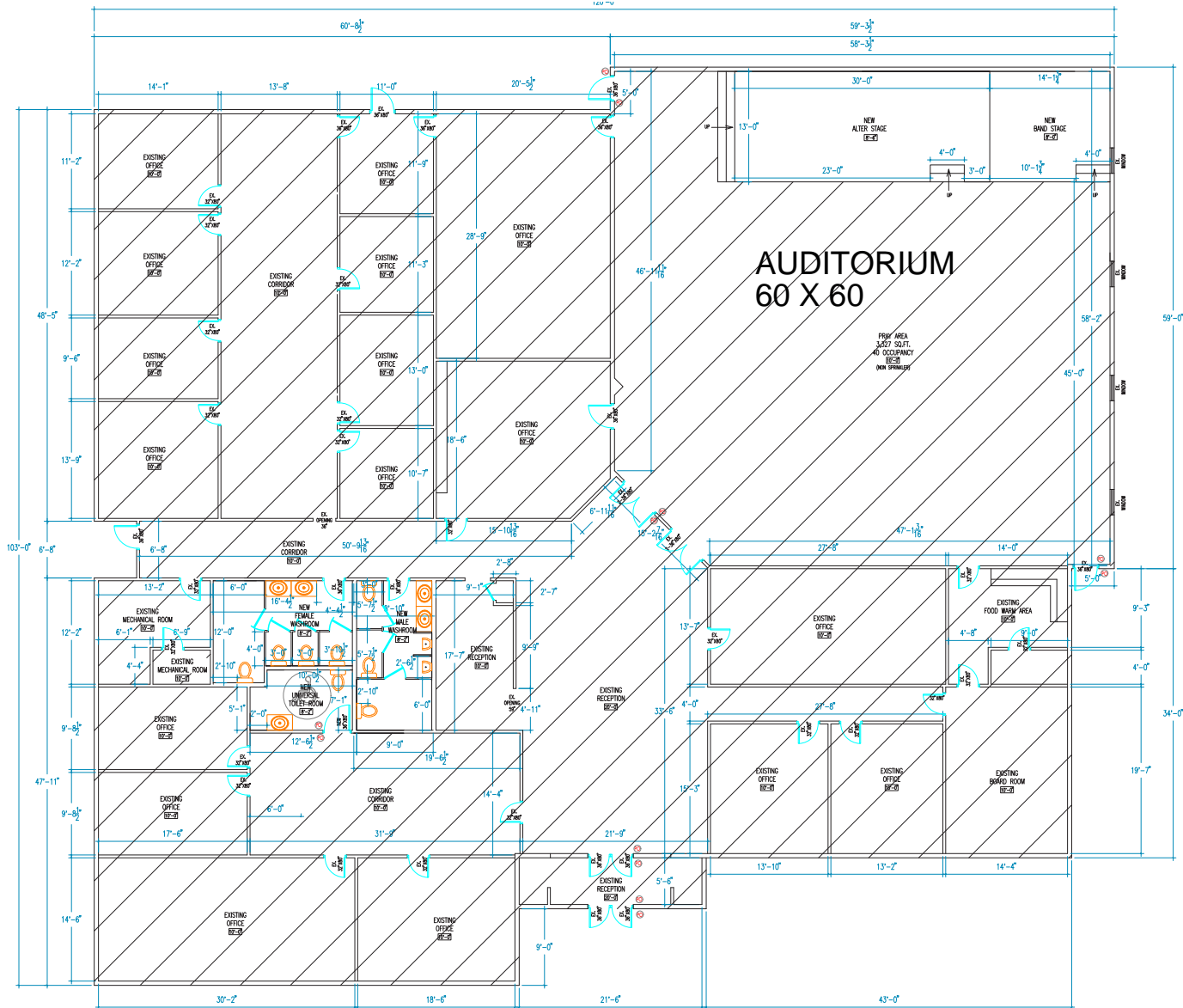

ZONING MAP





CONTACT

Chris Hourihan
Associate Vice President
C 204 995 0225
T 204 934 6215
chris.hourihan@cwstevenson.ca



**CUSHMAN &
WAKEFIELD**
Winnipeg



Stevenson

Independently Owned and Operated / A Member of the Cushman & Wakefield Alliance ©2025 Cushman & Wakefield. All rights reserved. The information contained in this communication is strictly confidential. This information has been obtained from sources believed to be reliable but has not been verified. NO WARRANTY OR REPRESENTATION, EXPRESS OR IMPLIED, IS MADE AS TO THE CONDITION OF THE PROPERTY (OR PROPERTIES) REFERENCED HEREIN OR AS TO THE ACCURACY OR COMPLETENESS OF THE INFORMATION CONTAINED HEREIN, AND SAME IS SUBMITTED SUBJECT TO ERRORS, OMISSIONS, CHANGE OF PRICE, RENTAL OR OTHER CONDITIONS, WITHDRAWAL WITHOUT NOTICE, AND TO ANY SPECIAL LISTING CONDITIONS IMPOSED BY THE PROPERTY OWNER(S). ANY PROJECTIONS, OPINIONS OR ESTIMATES ARE SUBJECT TO UNCERTAINTY AND DO NOT SIGNIFY CURRENT OR FUTURE PROPERTY PERFORMANCE.