



Only One (+/-) 1,637 sf Office Space Remaining

Location Features

Situated on the northeast corner of Edmonton Avenue and Broadway, immediately adjacent to the RBC Convention Centre in walking distance to the Legislative building, Cityplace, Canada Life Centre, Manitoba Courts and various amenities.

Property Highlights

- Newly renovated front entrance, lobby and elevator cabs
- Proudly welcoming our new tenant the law office of Pollock and Company with premium space remaining available for your organization
- Vibrant location with nearby amenities and summer food trucks on Broadway
- Close proximity to Skywalk connectivity starting at RBC Convention Centre
- Great public transportation access
- Elevator access and Handicap accessible
- Fools & Horses licensed coffee shop, which also serves light fare offering a convenient quick lunch on the main floor
- Professionally managed
- Perfect for law offices or professional services
- Remaining office is a corner office with abundant natural light from two sides

Lease Rate: \$11.75 psf Net
Additional rent: \$9.35 (2021 est.)
plus mgmt. fee and utilities

Chris Hourihan
Associate Vice President
T 204 934 6215
C 204 995 0225
chris.hourihan@cwstevenson.ca

Colin Gratton
Associate
T 204 928 5000
C 204 471 1270
colin.gratton@cwstevenson.ca

Cushman & Wakefield | Stevenson
200 - 55 Donald Street
Winnipeg, Manitoba R3C 1L8
T 204 928 5000

www.cwstevenson.ca

Independently Owned and Operated / A Member of the Cushman & Wakefield Alliance

©2022 Cushman & Wakefield. All rights reserved. The information contained in this communication is strictly confidential. This information has been obtained from sources believed to be reliable but has not been verified. NO WARRANTY OR REPRESENTATION, EXPRESS OR IMPLIED, IS MADE AS TO THE CONDITION OF THE PROPERTY (OR PROPERTIES) REFERENCED HEREIN OR AS TO THE ACCURACY OR COMPLETENESS OF THE INFORMATION CONTAINED HEREIN, AND SAME IS SUBMITTED SUBJECT TO ERRORS, OMISSIONS, CHANGE OF PRICE, RENTAL OR OTHER CONDITIONS, WITHDRAWAL WITHOUT NOTICE, AND TO ANY SPECIAL LISTING CONDITIONS IMPOSED BY THE PROPERTY OWNER(S). ANY PROJECTIONS, OPINIONS OR ESTIMATES ARE SUBJECT TO UNCERTAINTY AND DO NOT SIGNIFY CURRENT OR FUTURE PROPERTY PERFORMANCE.

COMMON AREAS



Independently Owned and Operated / A Member of the Cushman & Wakefield Alliance

©2022 Cushman & Wakefield. All rights reserved. The information contained in this communication is strictly confidential. This information has been obtained from sources believed to be reliable but has not been verified. NO WARRANTY OR REPRESENTATION, EXPRESS OR IMPLIED, IS MADE AS TO THE CONDITION OF THE PROPERTY (OR PROPERTIES) REFERENCED HEREIN OR AS TO THE ACCURACY OR COMPLETENESS OF THE INFORMATION CONTAINED HEREIN, AND SAME IS SUBMITTED SUBJECT TO ERRORS, OMISSIONS, CHANGE OF PRICE, RENTAL OR OTHER CONDITIONS, WITHDRAWAL WITHOUT NOTICE, AND TO ANY SPECIAL LISTING CONDITIONS IMPOSED BY THE PROPERTY OWNER(S). ANY PROJECTIONS, OPINIONS OR ESTIMATES ARE SUBJECT TO UNCERTAINTY AND DO NOT SIGNIFY CURRENT OR FUTURE PROPERTY PERFORMANCE.

UNIT 303

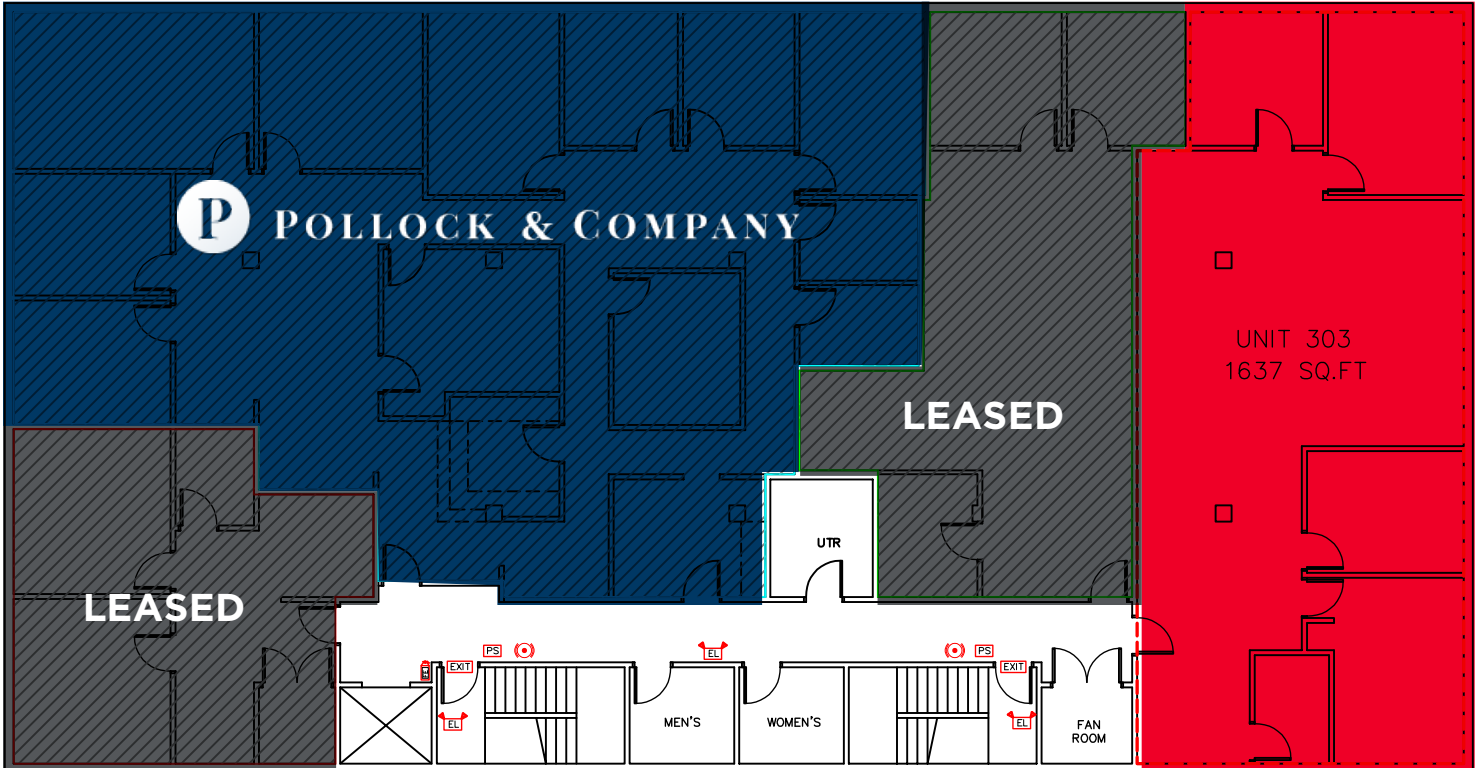

Independently Owned and Operated / A Member of the Cushman & Wakefield Alliance

©2022 Cushman & Wakefield. All rights reserved. The information contained in this communication is strictly confidential. This information has been obtained from sources believed to be reliable but has not been verified. NO WARRANTY OR REPRESENTATION, EXPRESS OR IMPLIED, IS MADE AS TO THE CONDITION OF THE PROPERTY (OR PROPERTIES) REFERENCED HEREIN OR AS TO THE ACCURACY OR COMPLETENESS OF THE INFORMATION CONTAINED HEREIN, AND SAME IS SUBMITTED SUBJECT TO ERRORS, OMISSIONS, CHANGE OF PRICE, RENTAL OR OTHER CONDITIONS, WITHDRAWAL WITHOUT NOTICE, AND TO ANY SPECIAL LISTING CONDITIONS IMPOSED BY THE PROPERTY OWNER(S). ANY PROJECTIONS, OPINIONS OR ESTIMATES ARE SUBJECT TO UNCERTAINTY AND DO NOT SIGNIFY CURRENT OR FUTURE PROPERTY PERFORMANCE.

AREA MAP

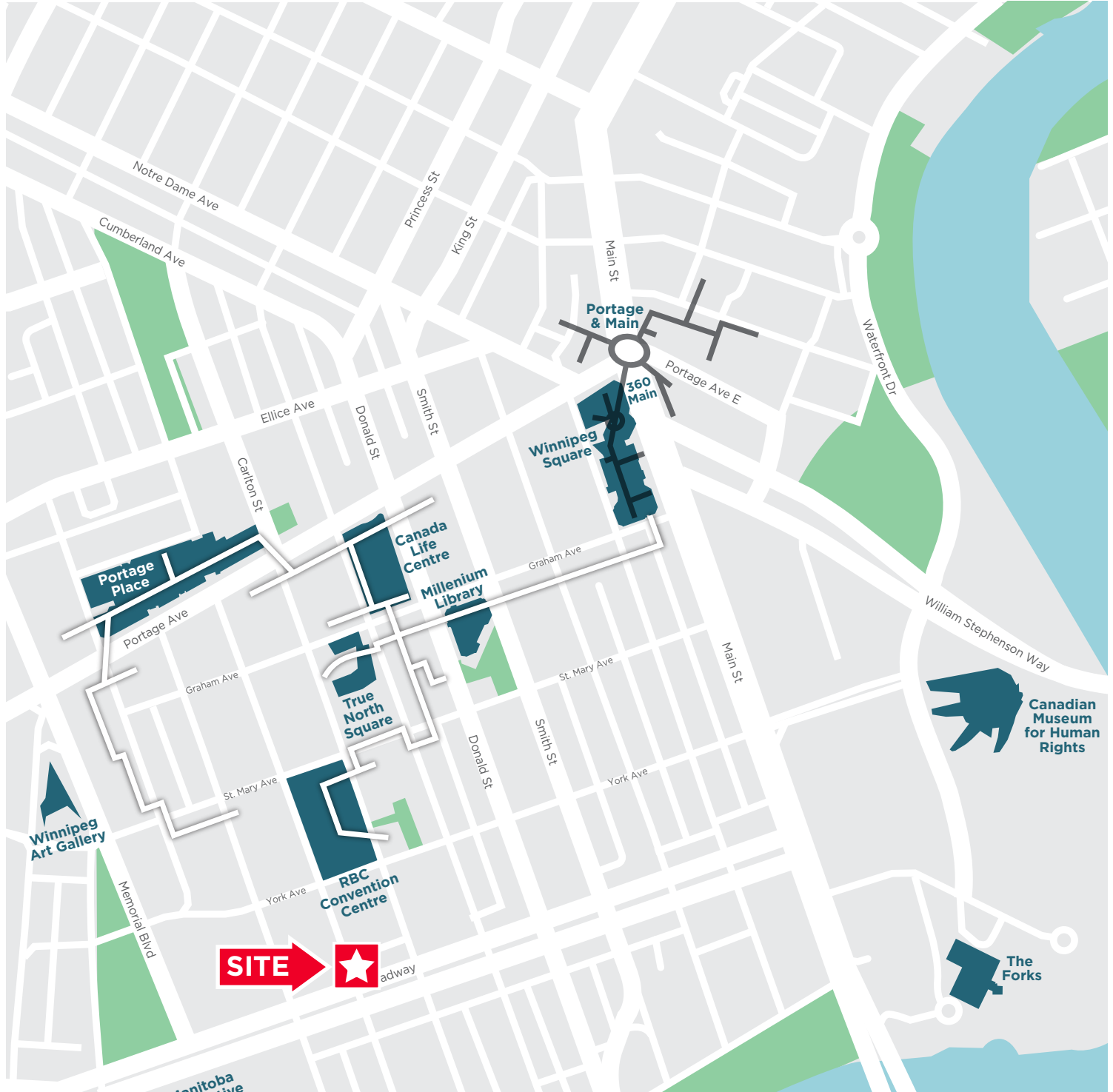

Independently Owned and Operated / A Member of the Cushman & Wakefield Alliance

©2022 Cushman & Wakefield. All rights reserved. The information contained in this communication is strictly confidential. This information has been obtained from sources believed to be reliable but has not been verified. NO WARRANTY OR REPRESENTATION, EXPRESS OR IMPLIED, IS MADE AS TO THE CONDITION OF THE PROPERTY (OR PROPERTIES) REFERENCED HEREIN OR AS TO THE ACCURACY OR COMPLETENESS OF THE INFORMATION CONTAINED HEREIN, AND SAME IS SUBMITTED SUBJECT TO ERRORS, OMISSIONS, CHANGE OF PRICE, RENTAL OR OTHER CONDITIONS, WITHDRAWAL WITHOUT NOTICE, AND TO ANY SPECIAL LISTING CONDITIONS IMPOSED BY THE PROPERTY OWNER(S). ANY PROJECTIONS, OPINIONS OR ESTIMATES ARE SUBJECT TO UNCERTAINTY AND DO NOT SIGNIFY CURRENT OR FUTURE PROPERTY PERFORMANCE.