



INDUSTRIAL FOR LEASE
359 JOHNSON AVE - UNIT B

STEPHEN SHERLOCK
Vice President

T 204 928 5011
C 204 799 5526
E steve.sherlock@cwstevenson.ca

CUSHMAN & WAKEFIELD | STEVENSON
200 - 55 DONALD STREET
WINNIPEG, MANITOBA R3C 1L8
T 204 928 5000
WWW.CWSTEVENSON.CA





PROPERTY HIGHLIGHTS

(+/-) 1,800 SF AVAILABLE

- Located on the corner of Johnson Avenue and Levis Street close to Chalmers Ave and Watt Street
- Office/ warehouse space with one private office, reception area and boardroom/ meeting room
- Warehouse space has 1 grade level loading door
- Zoned: M1

LEASE RATE: \$8.95 PSF NET

CAM & TAX: \$6.75 (2024 EST.)

*PLUS A 5% MANAGEMENT FEE BASED ON GROSS RENT



IMAGES



AREA OVERVIEW



HENDERSON

CHALMERS AVE

POPLAR AVE

JOHNSON AVE W

LEVIS ST

WATT ST

GORDON AVE

STADACONA ST

RIVERTON AVE

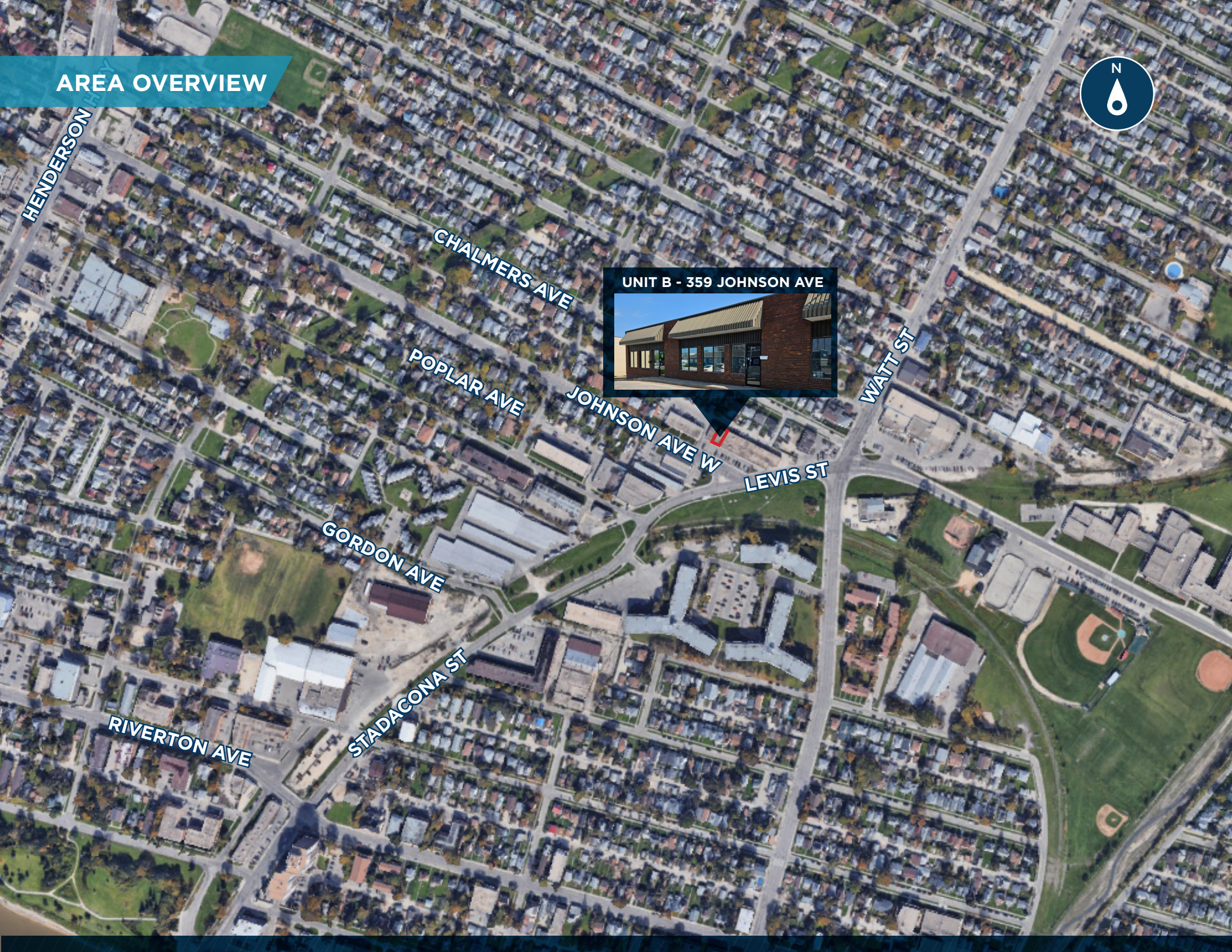

SITE PLAN

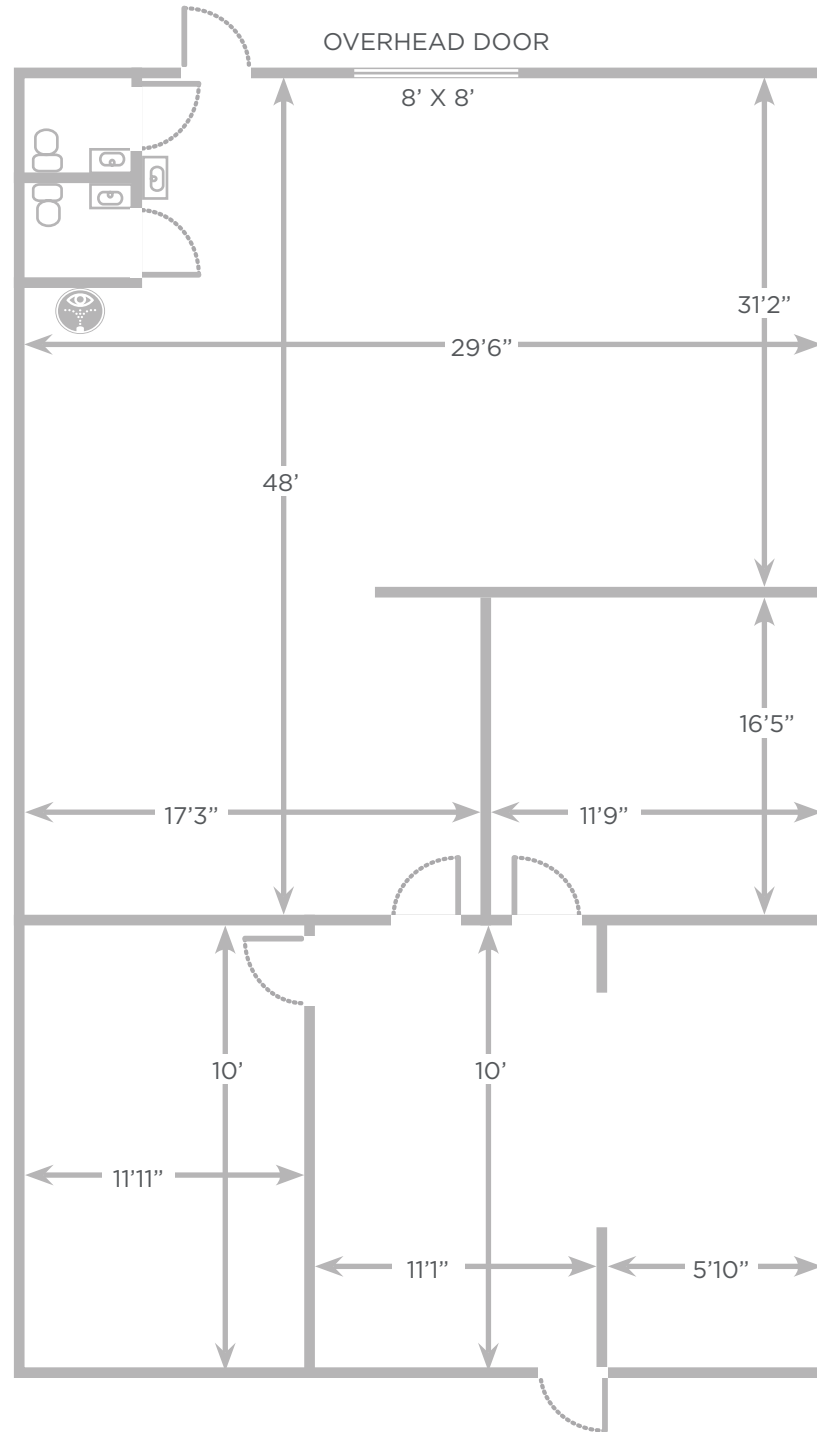



CONTACT

STEPHEN SHERLOCK
Vice President

T 204 928 5011
C 204 799 5526
E steve.sherlock@cwstevenson.ca

CUSHMAN & WAKEFIELD | STEVENSON
200 - 55 DONALD STREET
WINNIPEG, MANITOBA R3C 1L8
T 204 928 5000
WWW.CWSTEVENSON.CA



Independently Owned and Operated / A Member of the Cushman & Wakefield Alliance ©2023 Cushman & Wakefield. All rights reserved. The information contained in this communication is strictly confidential. This information has been obtained from sources believed to be reliable but has not been verified. NO WARRANTY OR REPRESENTATION, EXPRESS OR IMPLIED, IS MADE AS TO THE CONDITION OF THE PROPERTY (OR PROPERTIES) REFERENCED HEREIN OR AS TO THE ACCURACY OR COMPLETENESS OF THE INFORMATION CONTAINED HEREIN, AND SAME IS SUBMITTED SUBJECT TO ERRORS, OMISSIONS, CHANGE OF PRICE, RENTAL OR OTHER CONDITIONS, WITHDRAWAL WITHOUT NOTICE, AND TO ANY SPECIAL LISTING CONDITIONS IMPOSED BY THE PROPERTY OWNER(S). ANY PROJECTIONS, OPINIONS OR ESTIMATES ARE SUBJECT TO UNCERTAINTY AND DO NOT SIGNIFY CURRENT OR FUTURE PROPERTY PERFORMANCE.