

**COMPOUND SPACE  
AVAILABLE**

INDUSTRIAL FOR SUBLEASE  
**629 ERIN STREET**





## PROPERTY HIGHLIGHTS

### (+/-) 3,065 SF AVAILABLE

- Office/Warehouse for Sublease on Erin Street
- 10' x 10' grade loading door
- Fully sprinklered
- Open office area, washroom, server room and open warehouse space
- Headlease expiry: November 30, 2025

**LEASE RENT: \$13.50 PSF**

**CAM & TAX: \$6.68 PSF (2025 EST.)**

**MGMT FEE: 6% OF GROSS RENT**







# LOCATION OVERVIEW





# FLOOR PLAN

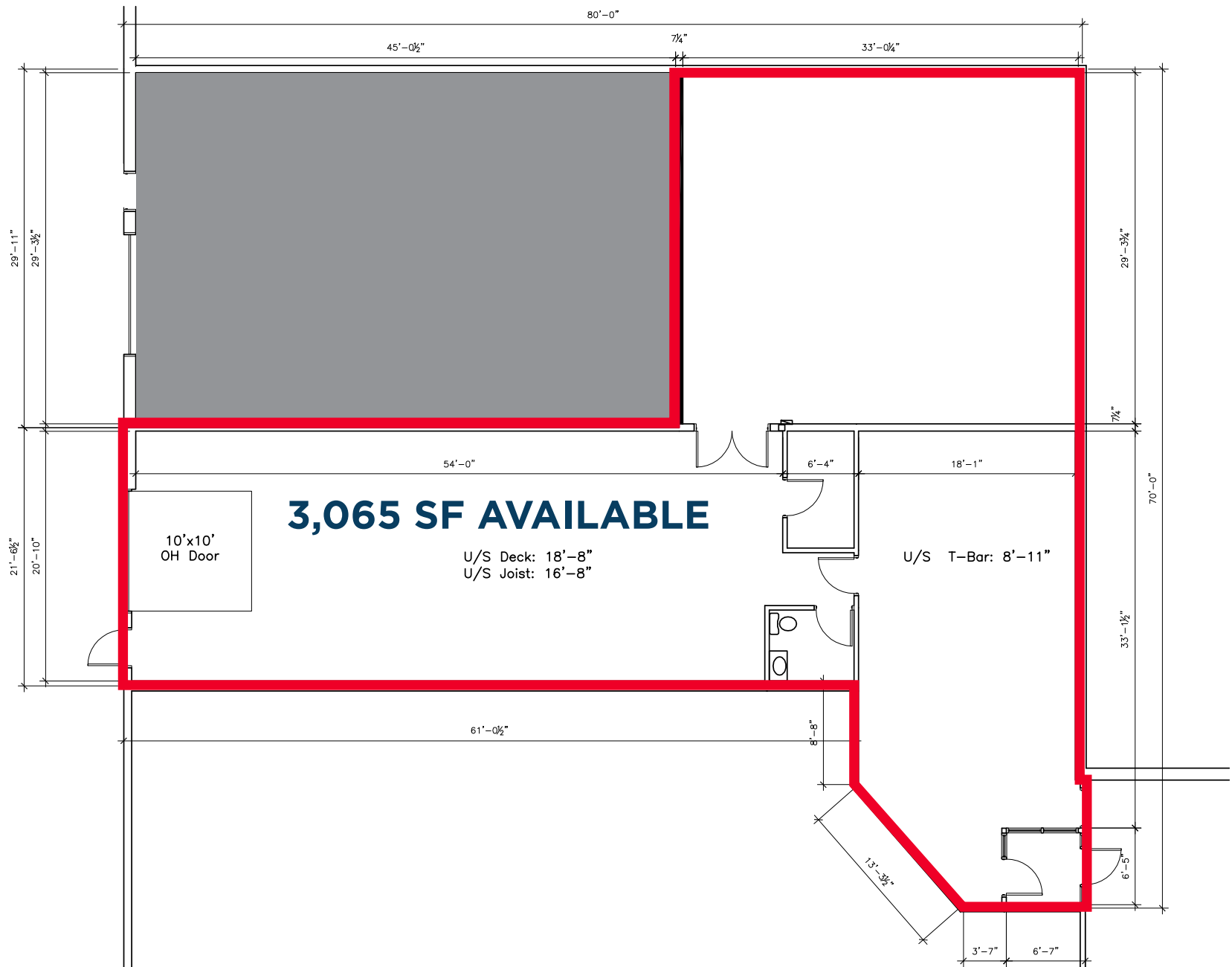



# AREA MAP



Elice Ave

St. James St

Empress St

St. Matthews Ave

Erin St

Wall St

Portage Ave

Polo Park

Portage Ave

★ SITE



Mark's



P.F. CHANG'S



Long & McQuade  
MUSICAL INSTRUMENTS



Flea & Whiskey's









## CONTACT

### RYAN MUNT

EXECUTIVE VICE PRESIDENT

RYAN MUNT PERSONAL REAL ESTATE CORPORATION

T 204 928 5015

C 204 298 1905

E [RYAN.MUNT@CWSTEVENSON.CA](mailto:RYAN.MUNT@CWSTEVENSON.CA)

### SHAE HALPIN

SENIOR ASSOCIATE

T 204 560 2536

C 204 558 6071

E [SHAE.HALPIN@CWSTEVENSON.CA](mailto:SHAE.HALPIN@CWSTEVENSON.CA)



Independently Owned and Operated / A Member of the Cushman & Wakefield Alliance ©2025 Cushman & Wakefield. All rights reserved. The information contained in this communication is strictly confidential. This information has been obtained from sources believed to be reliable but has not been verified. NO WARRANTY OR REPRESENTATION, EXPRESS OR IMPLIED, IS MADE AS TO THE CONDITION OF THE PROPERTY (OR PROPERTIES) REFERENCED HEREIN OR AS TO THE ACCURACY OR COMPLETENESS OF THE INFORMATION CONTAINED HEREIN, AND SAME IS SUBMITTED SUBJECT TO ERRORS, OMISSIONS, CHANGE OF PRICE, RENTAL OR OTHER CONDITIONS, WITHDRAWAL WITHOUT NOTICE, AND TO ANY SPECIAL LISTING CONDITIONS IMPOSED BY THE PROPERTY OWNER(S). ANY PROJECTIONS, OPINIONS OR ESTIMATES ARE SUBJECT TO UNCERTAINTY AND DO NOT SIGNIFY CURRENT OR FUTURE PROPERTY PERFORMANCE.