

FOR LEASE

Unit A 1000 Waverley Street

Fully Developed Office
Space Available

Ryan Munt
Executive Vice President

Ryan Munt Personal Real Estate Corporation
T 204 928 5015
C 204 298 1905
ryan.munt@cwstevenson.ca

Shae Halpin

Senior Associate
T 204 560 2536
C 204 558 6071
shae.halpin@cwstevenson.ca



**CUSHMAN &
WAKEFIELD**
Winnipeg



Stevenson

FOR LEASE

1000 Waverley Street



(+/-) 16,370 – 21,468 sf Available with 70 Parking Stalls

PROPERTY HIGHLIGHTS

- Fully-developed office space located in highly desirable Southwest Winnipeg
- Mix of private offices, large open areas, three boardrooms, four large training rooms, photo copier/mail room, one large lunch room, two kitchenettes and a garage with a grade loading door
- Well-situated within densely populated, amenity-rich area
- Building signage available with excellent visibility along Waverley Street
- City of Winnipeg transit stops going North and South located directly outside
- (+/-) 70 parking stalls available on site

Lease Rate: TBD

CAM & Tax: \$7.48 psf (2025 est.)

Includes utilities

Plus mgmt fee 5% of net rent

FOR LEASE

Unit A 1000 Waverley St



FOR LEASE

Unit A 1000 Waverley St



FOR LEASE

Unit A 1000 Waverley St



FLOOR PLAN

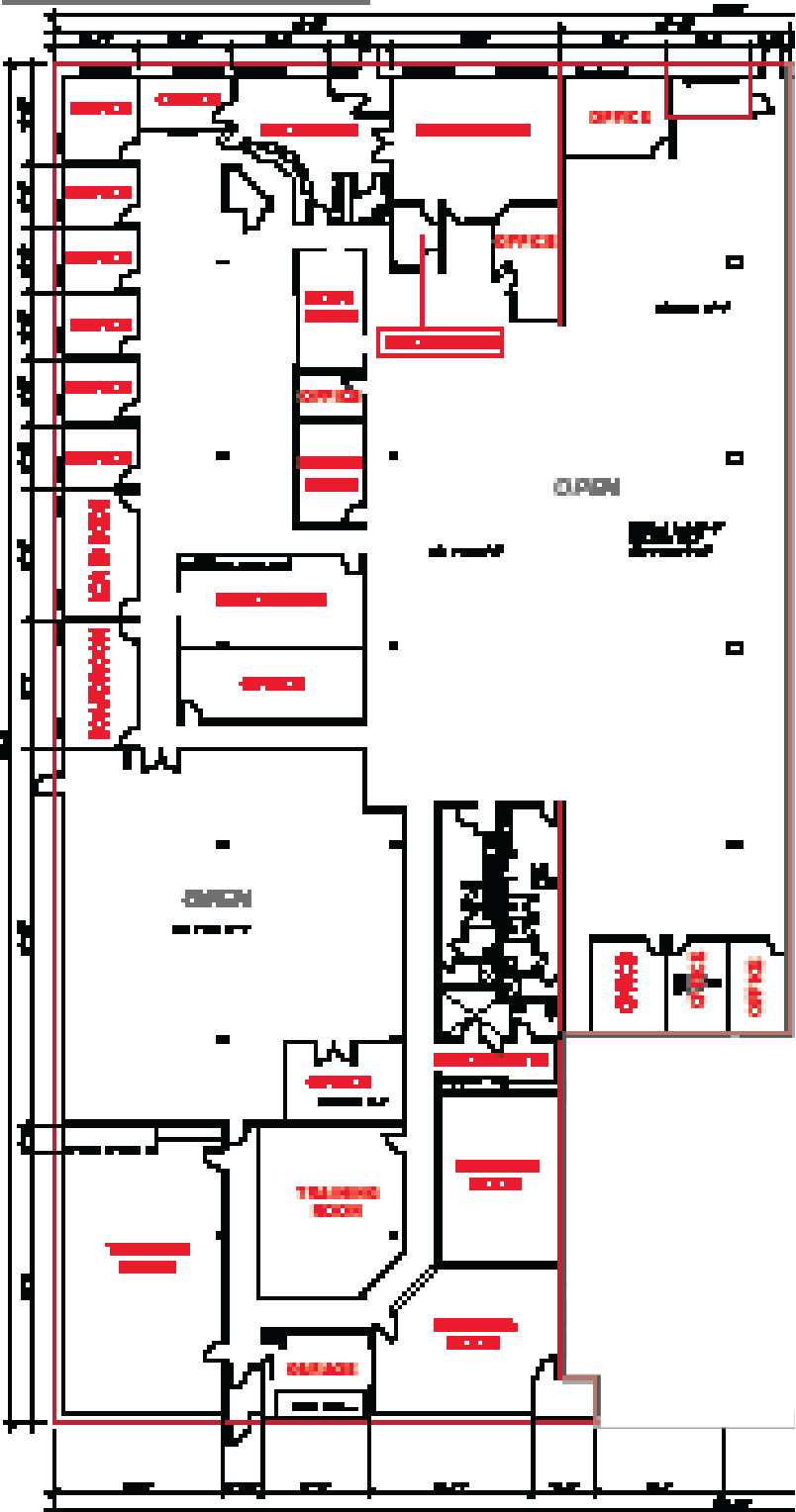

(+/-) 21,503 sf Available

Offices	15
Boardrooms	3
Kitchenettes	2
Lunchroom	1
Training Rooms	4
Tech Rooms	2
Garage	1

Independently Owned and Operated / A Member of the Cushman & Wakefield Alliance ©2025 Cushman & Wakefield. All rights reserved. The information contained in this communication is strictly confidential. This information has been obtained from sources believed to be reliable but has not been verified. NO WARRANTY OR REPRESENTATION, EXPRESS OR IMPLIED, IS MADE AS TO THE CONDITION OF THE PROPERTY (OR PROPERTIES) REFERENCED HEREIN OR AS TO THE ACCURACY OR COMPLETENESS OF THE INFORMATION CONTAINED HEREIN, AND SAME IS SUBMITTED SUBJECT TO ERRORS, OMISSIONS, CHANGE OF PRICE, RENTAL OR OTHER CONDITIONS, WITHDRAWAL WITHOUT NOTICE, AND TO ANY SPECIAL LISTING CONDITIONS IMPOSED BY THE PROPERTY OWNER(S). ANY PROJECTIONS, OPINIONS OR ESTIMATES ARE SUBJECT TO UNCERTAINTY AND DO NOT SIGNIFY CURRENT OR FUTURE PROPERTY PERFORMANCE.

FOR LEASE
Unit A 1000 Waverley St

SITE PLAN

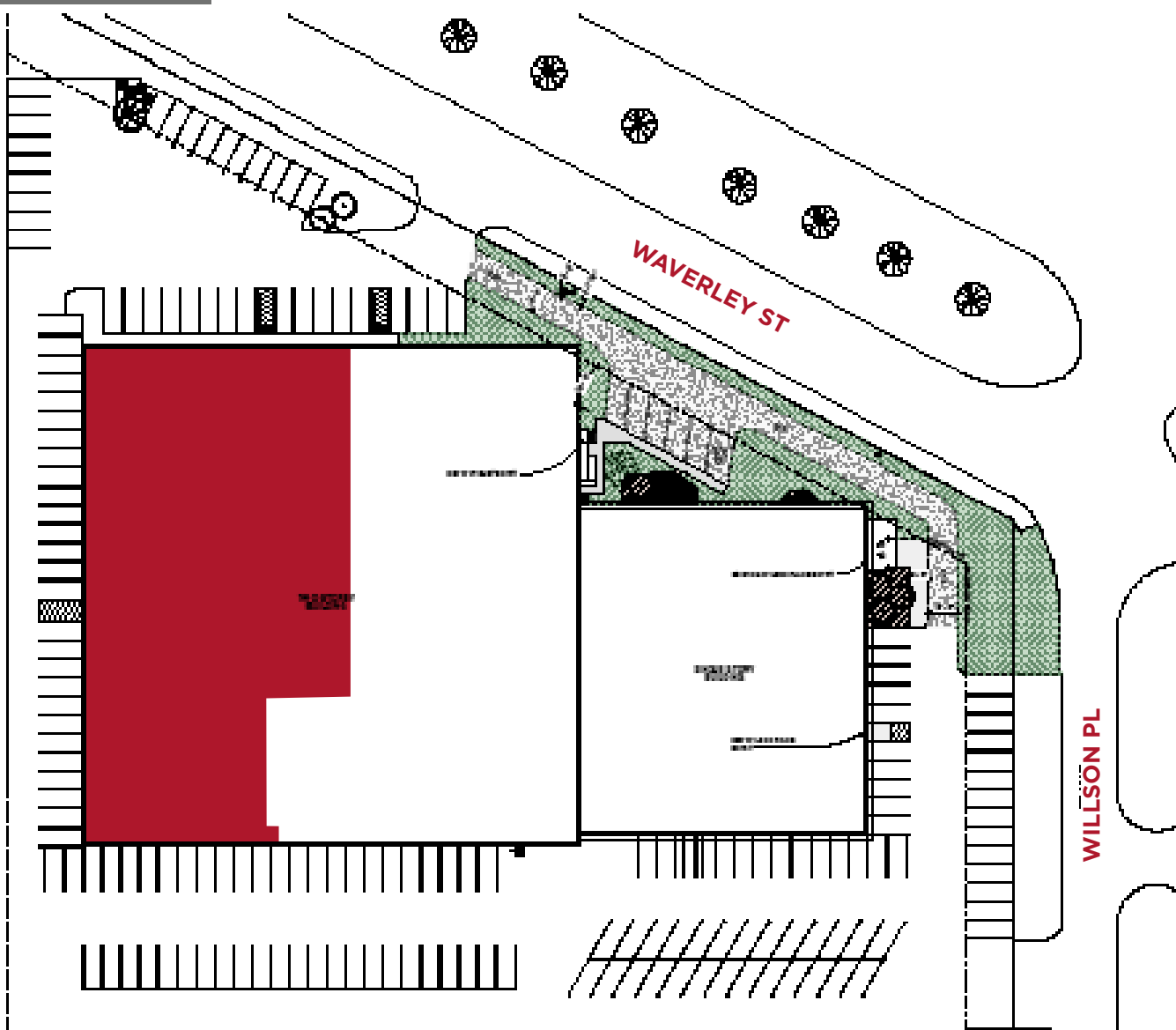

FOR LEASE

Unit A 1000 Waverley St

CUSHMAN & WAKEFIELD
Winnipeg

Stevenson



Independently Owned and Operated / A Member of the Cushman & Wakefield Alliance ©2025 Cushman & Wakefield. All rights reserved. The information contained in this communication is strictly confidential. This information has been obtained from sources believed to be reliable but has not been verified. NO WARRANTY OR REPRESENTATION, EXPRESS OR IMPLIED, IS MADE AS TO THE CONDITION OF THE PROPERTY (OR PROPERTIES) REFERENCED HEREIN OR AS TO THE ACCURACY OR COMPLETENESS OF THE INFORMATION CONTAINED HEREIN, AND SAME IS SUBMITTED SUBJECT TO ERRORS, OMISSIONS, CHANGE OF PRICE, RENTAL OR OTHER CONDITIONS, WITHDRAWAL WITHOUT NOTICE, AND TO ANY SPECIAL LISTING CONDITIONS IMPOSED BY THE PROPERTY OWNER(S). ANY PROJECTIONS, OPINIONS OR ESTIMATES ARE SUBJECT TO UNCERTAINTY AND DO NOT SIGNIFY CURRENT OR FUTURE PROPERTY PERFORMANCE.

Ryan Munt
Executive Vice President

Ryan Munt Personal Real Estate Corporation
T 204 928 5015
C 204 298 1905
ryan.munt@cwstevenson.ca

Shae Halpin

Senior Associate
T 204 560 2536
C 204 558 6071
shae.halpin@cwstevenson.ca

Independently Owned and Operated / A Member of the Cushman & Wakefield Alliance ©2025 Cushman & Wakefield. All rights reserved.
The information contained in this communication is strictly confidential.

This information has been obtained from sources believed to be reliable but has not been verified. NO WARRANTY OR REPRESENTATION, EXPRESS OR IMPLIED, IS MADE AS TO THE CONDITION OF THE PROPERTY (OR PROPERTIES) REFERENCED HEREIN OR AS TO THE ACCURACY OR COMPLETENESS OF THE INFORMATION CONTAINED HEREIN, AND SAME IS SUBMITTED SUBJECT TO ERRORS, OMISSIONS, CHANGE OF PRICE, RENTAL OR OTHER CONDITIONS, WITHDRAWAL WITHOUT NOTICE, AND TO ANY SPECIAL LISTING CONDITIONS IMPOSED BY THE PROPERTY OWNER(S). ANY PROJECTIONS, OPINIONS OR ESTIMATES ARE SUBJECT TO UNCERTAINTY AND DO NOT SIGNIFY CURRENT OR FUTURE PROPERTY PERFORMANCE.



**CUSHMAN &
WAKEFIELD**
Winnipeg



Stevenson